



**WIDEN YOUR VIEW.  
 STRETCH YOUR DOLLAR.**

If you're looking for a good deal, this affordable series of business projectors is your answer. On top of features such as home screen interface, and auto search function, a long lamp life and lasting maintenance cycle help you keep your business running smoothly and cost-efficiently.



EB-S31/X31/W31



EB-X04



10,000 Hours Lamp Life in Eco Mode



Multi-PC Projection



Horizontal Keystone Adjuster



HDMI



Split Screen



Environmentally-Friendly

**ENGINEERED FOR BUSINESS**

**Stunning Colour Brightness**

Achieve dazzling, sharp and colourful images with the high Colour Light Output.

**Seamless Connectivity and Usability**

Enjoy great convenience from ergonomic features ranging from split screen functionality to Epson iProjection.

**Essential Cost-savings**

Minimise costs with an impressive 10,000 hours for lamp life and maintenance cycle in eco-mode.



# SEE VIBRANT, REALISTIC COLOURS WITH HIGH COLOUR BRIGHTNESS.



\*Based on a third-party study made by Radius Global Market Research of nearly 900 participants in the US

See colours like never before. Epson 3LCD projectors deliver brilliant colours that match its white brightness to give you balanced, realistic, and vibrant images. It's no wonder Epson projectors are the people's preferred choice.



## Up to 3X Wider Colour Gamut

Colour gamut refers to the range of colours that can be reproduced by a display device – the wider the gamut, the more realistic it is. Epson 3LCD projectors project three times wider gamut that matches closely to the original standard of a display device (sRGB), as compared to 1-chip projectors.

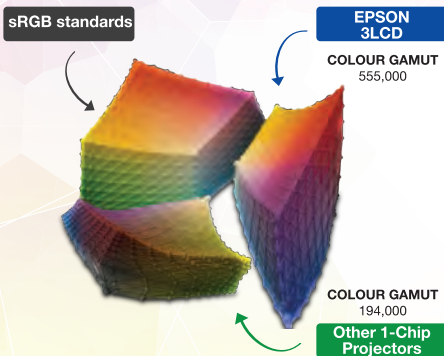

Comparing the yellow corners among the three gamuts, 1-chip projectors have a distinctly darker and smaller set of colours which are not as vibrant as Epson 3LCD projectors.



\*Compared against similarly-priced leading 1-chip DLP® business and education projectors based on NPD data from July 2011 through June 2012 (available from [www.npd.com](http://www.npd.com)). Colour brightness (colour light output) measured in accordance with IDMS 15.4. Actual colour brightness will vary depending on actual usage conditions. 3LCD® is a registered trademark of Seiko Epson Corporation, DLP® is a registered trademark of Texas Instruments, Inc. and its use here does not imply any affiliation with or endorsement by them.



## Up to 3X Brighter Colours

Epson 3LCD projectors deliver up to three times the colour brightness, effortlessly creating the same colour and white brightness, resulting in faithful images with superior colour balance.



## No Rainbow Effect

With 1-chip projectors, the spinning motion of the sequential colour wheels tend to cause colours to break out into distinct red, green and blue. Called the rainbow effect, this may cause users to suffer headaches with prolonged viewing. Epson projectors do not give out this effect, giving users a comfortable experience.



[www.epson.com.my/colourbrightness](http://www.epson.com.my/colourbrightness)

To learn more about 3LCD engines, visit [www.3lcd.com](http://www.3lcd.com)

With ergonomic features such as auto-power on and source search, these projectors deliver smooth and high-contrast presentations whenever and wherever you need.



## Impressive Image Quality

### High Contrast Ratio

Add brilliance to your presentations. Boasting stunning brightness of up to 3,200 lumens and a high contrast ratio of 15000:1, these projectors enable you to project beautiful, well-defined images wherever you are, regardless of ambient light.



## Seamless Connectivity and Usability

### Epson iProjection\*

The iProjection application enables a wireless connection for projecting images and files from your smart devices. The "QR Code Reader" function makes this wireless connection even easier by simply reading the QR code that is projected on the screen from your smart devices.



\* In iProjection, projector profile search, multi-screen display, distribution function, audio transfer, movie file transfer, interrupt connection disabling and encryption data transfer capabilities are not supported.



### Horizontal Keystone Adjuster

Deliver powerful presentations anywhere in the room. The easy-to-use sliding Horizontal Keystone Adjuster means screen corrections can be done quickly, easily and accurately, even in a limited space.

And with automatic vertical keystone detection and adjustment, there is no longer any need for awkward and time-consuming manual image adjustments that interrupt the smooth flow of your presentation delivery. This handy feature automatically detects the projector's vertical keystone distortion and corrects it instantly.

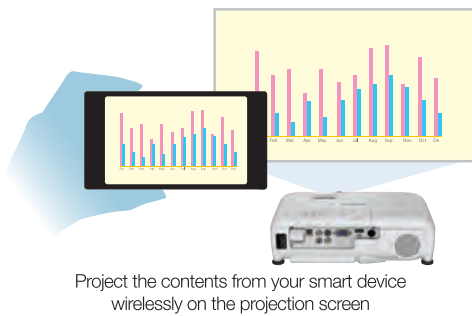
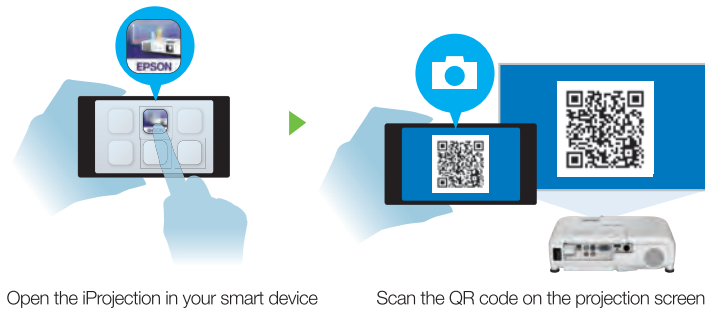

### Wide-ranging Connectivity

Advanced connectivity features mean convenient and hassle-free projections for your presentations. With a wide-ranging interface, you can choose from a variety of connection methods including HDMI, VGA and LAN.

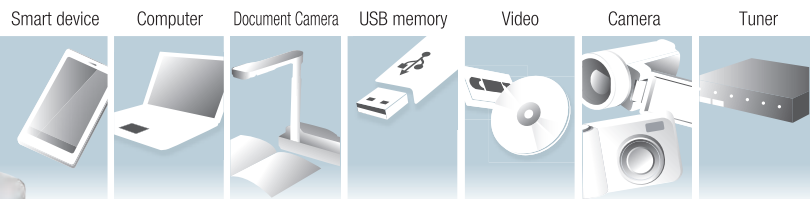

## Wireless Transmission

Enjoy enhanced connectivity and flexibility with optional Wi-Fi® connectivity. Easily share and transmit images, texts and files from your smart devices using the “Epson iProjection” application for smooth and smart projections.



## Split Screen

Display images from two different sources side by side on the same screen for a more effective presentation. In video conferences, for example, images of presentation materials and remote participants can be shown simultaneously.



## Multi-PC Projection

With the control of a host PC, up to 50 terminals can be connected via the multi-PC projection to a single projector. The host PC acts as a moderator, selecting media from up to four PCs or smart devices to be projected simultaneously. With the moderator function, you can maintain control and prevent tampering of what's projected on screen.



## Home Screen

View and access your most frequently used functions immediately on the home screen. See all source information at a glance, no matter what the source input. With all the information you need right there on the home screen, wireless connections have never been easier.



## Auto Power On

With the auto power on function, projection starts automatically once a projection signal is detected via VGA cable, providing you with an easy and hassle-free presentation.



## Auto Source Search

With automatic detection of the input source, projection automatically begins without you having to manually switch the input.



## Redirected Exhaust

The front-facing exhaust is intelligently positioned to prevent anyone from being exposed to the hot exhaust, especially when on a narrow table. This allows your audience to fully concentrate on the presentation, even if they are seated beside or behind the projector.



Other projectors with side exhaust

## Essential Cost-savings

### Longer Lamp Life

With a long lamp life of 10,000 hours in eco-mode, the frequency of costly lamp replacements is reduced, saving you time and money.

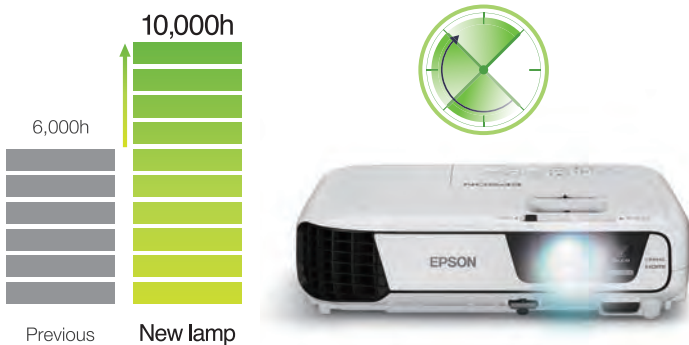

### Air Filter

With a maintenance cycle of 10,000 hours in eco-mode, the need for regular maintenance of the air filter is minimised to save you time and money.

### Easy Lamp Replacement

With the lamp cap located on the upper side of the projector, you can change lamps easily even if the projector is installed on the ceiling. Lamps can be replaced quickly without tools and dismantling of the projector from the ceiling mount.



## Eco Features

- Uses just 0.26W of power in standby mode
- Projector optics employ lead-free lenses
- Unpainted plastic housing reduces the environment impact
- The flame retardants used in the plastic housing do not contain chlorine or bromine

## Better Products for a Better Future™

For more information on Epson's environmental programmes, visit <http://global.epson.com/SR/environment>.

## PARTNERS IN PERFECTION

### Wireless LAN Adaptor ELPAP10



Supports 802.11 b/g/n connection  
Compatible with selected Epson wireless-enabled projectors

### Ink Tank System Printer L365



Print Speed : Approx. 9.2ipm for default black and white prints  
Resolution : 5760 x 1440dpi  
Connectivity : Built-in WiFi, Epson Connect  
Print, copy scan

<b>MODEL NUMBER</b>	<b>EB-W31</b>	
<b>Projection Technology</b>	RGB liquid crystal shutter projection system	
<b>Specifications of Main Parts</b>		
LCD	Size	0.59" (D9, C <sup>2</sup> fine)
	Native Resolution	WXGA
Projection Lens	Type	Optical Zoom (Manual) / Focus (Manual)
	F-Number	1.58 - 1.72
	Focal Length	16.9 - 20.28 mm
	Zoom Ratio	1 - 1.2
	Throw Ratio	1.30 - 1.56 (Wide - Tele)
Lamp	Type	200W UHE
	Life (Normal / Eco) <sup>1</sup>	5,000 hours / 10,000 hours
<b>Screen Size (Projected Distance)</b>		
Zoom: Wide	33" - 320" [0.9 - 9.0 m]	
Zoom: Tele	33" - 320" [1.08 - 10.8 m]	
Standard Size	60" screen 1.68 - 2.02 m	
<b>Brightness<sup>2</sup></b>		
White Light Output (Normal / Eco)	3,200lm / 2,240lm	
Colour Light Output	3,200lm	
<b>Contrast Ratio</b>	15,000:1	
<b>Internal Speaker(s)</b>		
Sound Output	2W Monaural	
<b>Geometric Correction</b>		
Keystone	Vertical / Horizontal	±30° / ±30°
Auto Keystone Correction	Yes (Vertical only)	
Horizontal Slide Keystone Correction	Yes	
Quick Corner	Yes	
<b>Connectivity</b>		
Analog Input	D-Sub 15pin	1 (Blue molding)
	Composite	RCA x 1 (Yellow)
	S-Video	1
Digital Input	HDMI	1 (MHL supported)
Audio Input	2 RCA (White / Red)	1
USB Interface	USB Type A	1 (for USB Memory, Document Camera, Wireless LAN, Firmware Update)
	USB Type B	1 (for USB Display, Mouse, K/B, Control, Firmware Update)
Network	Wireless	Optional (ELPAP10)
<b>Wireless Specifications</b>		
Supported Speed For Each Mode <sup>3</sup>	IEEE 802.11b: 11 Mbps, IEEE 802.11g: 54 Mbps, IEEE 802.11n: 130 Mbps	
Wireless LAN Security	WPA-PSK/WPA2-PSK(TKIP/AES), WPA2-PSK(AES) (Optional Wireless LAN Unit use)	
Supported Connection Mode	Infrastructure, Access Point	
<b>Operating Temperature</b>		
	5 - 35 °C <41 - 95 °F> (0m / 0ft - 2,286m / 7,500ft)	
	5 - 30 °C <41 - 86 °F> (over 2,286m / 7,500ft)	
	(20% - 80% humidity, No condensation)	
<b>Operating Altitude</b>		
	0 - 3,000 m <0 - 9,843 ft> (over 1,500m / 4,921ft: with high altitude mode)	
<b>Direct Power On / Off</b>	Yes	
<b>Start-Up Period</b>	About 6 seconds, Warm-up Period: 30 seconds	
<b>Cool Down Period</b>	Instant Off	
<b>Air Filter</b>		
Maintenance Cycle	5,000 hours / 10,000 hours (Power consumption: Normal / Eco) <sup>4</sup>	
<b>Power Supply Voltage</b>	100 - 240 V AC ±10%, 50/60 Hz	
<b>Power Consumption (220 - 240V)</b>		
Lamp On (Normal / Eco)	277W / 207W	
Standby (Network On / Off)	2.4W / 0.26W	
<b>Dimension Excluding Feet (D X W X H)</b>	234 x 297 x 77 mm	
<b>Weight</b>	2.4kg	
<b>Fan Noise (Normal / Eco)</b>	37dB / 28dB	
<b>Warranty</b>		
Main Unit	2 years carry-in	

<sup>1</sup> Lamp life will vary depending upon mode selected, environmental conditions and usage. Lamp brightness decreases over time.

<sup>2</sup> Colour brightness (colour light output) and white brightness (white light output) will vary depending on usage conditions. Colour light output measured in accordance with IDMS 15:4; white light output measured in accordance with ISO 21118.

<sup>3</sup> Maximum speed and range is achievable when used with same enhanced mode technology. Actual data rates, features and performance may vary depending on your computer system, the environment and other factors.

<sup>4</sup> When used in the general office environment (the amount of floating dust: 0.04 - 0.2 mg/m<sup>3</sup>). Based on the Epson's in-house test results.

**Supplied Accessories**

Power Cable: 1.8m  
Computer Cable (VGA Cable): 1.8m  
USB Cable (Type A/B): 1.8m  
Remote Control: Yes, with Alkaline AA Battery x 2  
Soft Carrying Case

**Optional Accessories**

Spare Lamp: ELPLP88  
Air Filter: ELPAF32  
Wireless LAN: ELPAP10  
Quick Wireless Connection USB Key: ELPAP09  
Ceiling Mount (White Colour): ELPMB23

EB-W31



©2015 Epson Singapore Pte Ltd. All Rights Reserved. Reproduction in part or in whole, without the written permission from Epson, is strictly prohibited.

EPSON and EXCEED YOUR VISION are registered trademarks of Seiko Epson Corporation.

All other product names and other company names used herein are for identification purposes only and are the trademarks or registered trademarks of their respective owners.

Epson disclaims any and all rights in those marks. Projected images shown herein are simulations. The actual product design and contents may vary. Specifications are subject to change without notice and may vary between countries. Please check with local Epson offices for more information.

Apple, iPad and iPhone are trademarks of Apple Inc., registered in the U.S. and other countries. App Store is a service mark of Apple Inc.

Android is a trademark of Google Inc.

Dealer's Stamp

Information correct at time of printing  
Printed July 2015

To find out more, visit [www.epson.com.my/projectors](http://www.epson.com.my/projectors) or call **1800-8-17349 (Toll-free)**

Join us on EpsonMalaysia

**Epson Malaysia Sdn Bhd (211204-X) 3rd Floor, East Tower, Wisma Consplant 1, No. 2, Jalan SS16/4, 47500 Subang Jaya, Selangor Darul Ehsan. Tel: 603-56 288 288 Fax: 603 56 212 088**  
Epson is the registered trademark of Seiko Epson Corporation. All other product names and other company names used herein are for caption purposes only and are the trademarks or registered trademarks of their respective owners. EPSON disclaims any and all rights in those marks. Scan/Print samples shown here are simulations. Specifications are subject to change without notice.

MODEL NUMBER	EB-S31	EB-X04	EB-X31
<b>Projection Technology</b>	RGB liquid crystal shutter projection system		
<b>Specifications of Main Parts</b>			
LCD	0.55" (D7)	0.55" (D8)	0.55" (D9, C <sup>2</sup> fine)
Native Resolution	SVGA	XGA	
Projection Lens	No Optical Zoom / Focus (Manual)		
Type	Optical Zoom (Manual) / Focus (Manual)		
F-Number	1.44	1.58 - 1.72	
Focal Length	16.7mm	16.9 - 20.28 mm	
Zoom Ratio	1.0 - 1.35 (Digital Zoom)	1 - 1.2	
Throw Ratio	1.45 - 1.96 (Wide - Tele)	1.48 - 1.77 (Wide - Tele)	
Lamp	200W UHE		
Type	200W UHE		
Life (Normal / Eco) <sup>1</sup>	5,000 hours / 10,000 hours		
<b>Screen Size (Projected Distance)</b>			
Zoom: Wide	30" - 350" [0.88 - 10.44 m]	30" - 300" [0.9 - 9.0 m]	
Zoom: Tele	23" - 260" [0.88 - 10.44 m]	30" - 300" [1.08 - 10.8 m]	
Standard Size	60" screen 1.77 - 2.4 m	60" screen 1.8 - 2.17 m	
<b>Brightness<sup>2</sup></b>			
White Light Output (Normal / Eco)	3,200lm / 2,240lm	2,800lm / 1,960lm	3,200lm / 2,240lm
Colour Light Output	3,200lm	2,800lm	3,200lm
<b>Contrast Ratio</b>	15,000:1		
<b>Internal Speaker(s)</b>			
Sound Output	2W Monaural	1W Monaural	2W Monaural
<b>Geometric Correction</b>			
Keystone	Vertical / Horizontal ±30° / ±30°		
Auto Keystone Correction	Yes (Vertical only)		
Horizontal Slide Keystone Correction	Yes		
Quick Corner	Yes		
<b>Connectivity</b>			
Analog Input	D-Sub 15pin		
	Composite		
	S-Video		
Digital Input	HDMI		
Audio Input	2 RCA (White / Red)		
USB Interface	USB Type A		
	USB Type B		
Network	Wireless		
<b>Wireless Specifications</b>			
Supported Speed For Each Mode <sup>3</sup>	IEEE 802.11b: 11 Mbps, IEEE 802.11g: 54 Mbps, IEEE 802.11n: 130 Mbps		
Wireless LAN Security	WPA-PSK/WPA2-PSK(TKIP/AES), WPA2-PSK(AES) (Optional Wireless LAN Unit use)		
Supported Connection Mode	Infrastructure, Access Point		
<b>Operating Temperature</b>			
	5 - 35 °C <41 - 95 °F> (0m / 0ft - 2,286m / 7,500ft)		
	5 - 30 °C <41 - 86 °F> (over 2,286m / 7,500ft)		
	(20% - 80% humidity, No condensation)		
<b>Operating Altitude</b>			
	0 - 3,000 m <0 - 9,843 ft> (over 1,500m / 4,921ft: with high altitude mode)		
<b>Direct Power On / Off</b>	Yes		
<b>Start-Up Period</b>	About 6 seconds, Warm-up Period: 30 seconds		
<b>Cool Down Period</b>	Instant Off		
<b>Air Filter</b>			
Maintenance Cycle	5,000 hours / 10,000 hours (Power consumption: Normal / Eco) <sup>4</sup>		
<b>Power Supply Voltage</b>	100 - 240 V AC ±10%, 50/60 Hz		
<b>Power Consumption (220 - 240V)</b>			
Lamp On (Normal / Eco)	277W / 207W		
Standby (Network On / Off)	2.4W / 0.26W		
<b>Dimension Excluding Feet (D X W X H)</b>	234 x 297 x 77 mm		
<b>Weight</b>	2.4kg		
<b>Fan Noise (Normal / Eco)</b>	37dB / 28dB		
<b>Warranty</b>			
Main Unit	2 years carry-in		

**Supplied Accessories**

Power Cable: 1.8m  
Computer Cable (VGA Cable): 1.8m  
USB Cable (Type A/B): 1.8m (EB-X31, EB-S31)  
Remote Control: Yes, with Alkaline AA Battery x 2  
Soft Carrying Case

**Optional Accessories**

Spare Lamp: ELPLP88  
Air Filter: ELPAF32  
Wireless LAN: ELPAP10  
Quick Wireless Connection USB Key: ELPAP09  
Ceiling Mount (White Colour): ELPMB23

EB-S31/X04/X31



©2015 Epson Singapore Pte Ltd. All Rights Reserved. Reproduction in part or in whole, without the written permission from Epson, is strictly prohibited.

EPSON and EXCEED YOUR VISION are registered trademarks of Seiko Epson Corporation.

All other product names and other company names used herein are for identification purposes only and are the trademarks or registered trademarks of their respective owners.

Epson disclaims any and all rights in those marks. Projected images shown herein are simulations. The actual product design and contents may vary. Specifications are subject to change without notice and may vary between countries. Please check with local Epson offices for more information.

Apple, iPad and iPhone are trademarks of Apple Inc., registered in the U.S. and other countries. App Store is a service mark of Apple Inc.

Android is a trademark of Google Inc.

Dealer's Stamp

Information correct at time of printing  
Printed July 2015

<sup>1</sup> Lamp life will vary depending upon mode selected, environmental conditions and usage. Lamp brightness decreases over time.

<sup>2</sup> Colour brightness (colour light output) and white brightness (white light output) will vary depending on usage conditions. Colour light output measured in accordance with IDMS 15:4; white light output measured in accordance with ISO 21118.

<sup>3</sup> Maximum speed and range is achievable when used with same enhanced mode technology. Actual data rates, features and performance may vary depending on your computer system, the environment and other factors.

<sup>4</sup> When used in the general office environment (the amount of floating dust: 0.04 - 0.2 mg/m<sup>3</sup>). Based on the Epson's in-house test results.

To find out more, visit [www.epson.com.my/projectors](http://www.epson.com.my/projectors) or call **1800-8-17349 (Toll-free)**

Join us on EpsonMalaysia

**Epson Malaysia Sdn Bhd (211204-X) 3rd Floor, East Tower, Wisma Consplant 1, No. 2, Jalan SS16/4, 47500 Subang Jaya, Selangor Darul Ehsan. Tel: 603-56 288 288 Fax: 603 56 212 088**  
Epson is the registered trademark of Seiko Epson Corporation. All other product names and other company names used herein are for caption purposes only and are the trademarks or registered trademarks of their respective owners. EPSON disclaims any and all rights in those marks. Scan/Print samples shown here are simulations. Specifications are subject to change without notice.